

Frozen Beverage Granita Machines

Procedures

Follow these procedures for each bowl to keep the machine clean and operating properly.

Refer to the operators manual for detailed information regarding machine operation.

NOTE

Inspect the parts for wear during the disassembly. Replace any worn or broken parts immediately.

A. Emptying the Bowl

1. On the right bowl, set the main power switch to the I position. On all bowls, set the Cold Drink/Granita switches to the Cold Drink setting.
2. Remove the condensation ring located under the spigot.
3. After about 5 minutes, open the spigot to drain to bowl.
4. Stop the clean cycle by placing main power switch off.
5. Fill the bowl with cool tap water. Time Saver Tip: use Stera-Sheen solution (prepared following manufacturers instructions) to increase efficiency when cleaning parts.

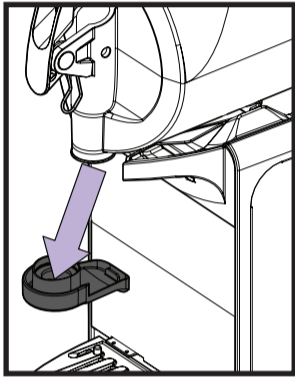

NOTE

Running Stera-Sheen solution through the machine makes cleaning parts easier after disassembly.

6. Place the main power switch on and let the auger rotate for at least 30 seconds.
7. Drain the water out of the machine then turn the machine off. Unplug the machine.

B. Disassembly

Disassembly of Bowl

1. Remove the top cover from the bowl by pressing the lock button and sliding the cover forward.
2. Push the metal bowl lever upwards and slide the bowl forwards. The lever is located on the underside of the bowl next to the spigot.

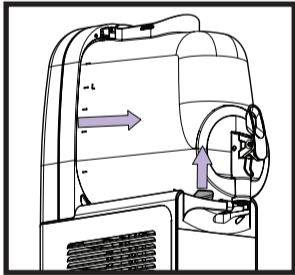

Disassembly of Auger

1. Slide the auger forwards off the evaporator.

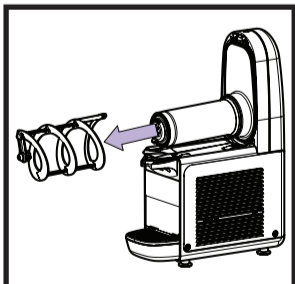

2. Remove the outer magnetic rotor assembly. The assembly is secured to the evaporator by a magnet and may need sufficient force to break the magnetic field.

B. Disassembly (continued)

3. Remove the bowl gasket.
4. Remove the spigot pin and pull the spigot assembly upwards.

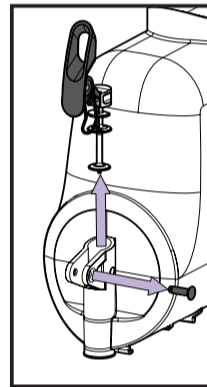
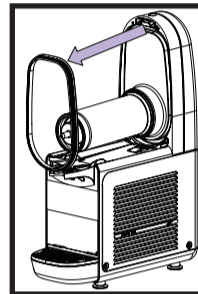

C. Cleaning

Cleaning Disassembled Parts

1. Place all parts in 90° to 110°F mild detergent water and wash thoroughly. Use the brushes to thoroughly clean parts.
2. Rinse, then place all parts in a sanitizing solution for at least 1 minute.
3. Let the parts air dry completely before assembling in machine.

Cleaning the Machine

1. Clean the evaporator cylinder with a large brush and sanitizing solution.
2. Wash all surfaces of the machine to remove spilled or dried mix.
3. Remove the drip tray. Clean and replace the tray.

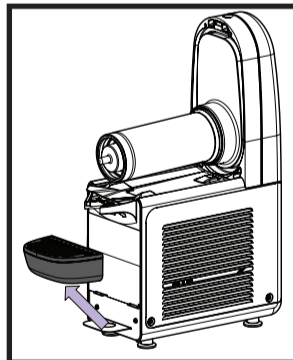

D. Assembly

Installing Spigot

1. Lubricate the edges of the spigot with Total Blend lubricant.
2. Install the spigot into the front of the bowl and secure it with the spigot pin.

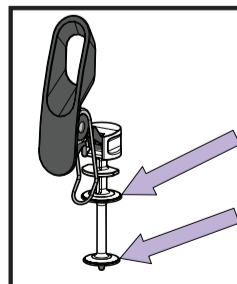

D. Assembly (continued)

3. Install the outer magnetic rotor assembly onto the front of the evaporator.
4. Slide the auger onto the evaporator and rotate it so that it engages the coupling.
5. Apply Total Blend to the magnetic rotor assembly, and the auger at the points.

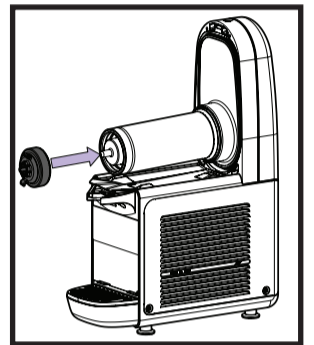

Installing Bowl

1. Install the bowl gasket making sure the large diameter is against the rear wall.
2. Slide the bowl onto the machine and push it back until the bowl lever engages.

E. Sanitizing & Startup

Sanitizing Machine

1. Prepare 2 gallons of Stera-Sheen sanitizing solution for each bowl following the manufacturer's instructions.
2. Pour the sanitizing solution into the bowls.
3. Plug the machine in and set the power switch to the I position.



4. Use a sanitized soft bristle brush dipped in sanitizing solution to clean the bowl sides and underside of the bowl cover.
5. After about 5 minutes open the spigot and drain the solution.
6. Set the power switch to the 0 position. Allow the bowl to drain completely.

Freeze Down and Operation

1. Sanitize immediately before use.
2. Fill the bowl with chilled mix.
3. Set the power switch to the I position.
4. Set the Cold Drink / Granita switch to the desired setting.
5. Set the light switch to the I position.

Follow Local Codes

Some local and state health codes dictate the frequency and procedure for cleaning and sanitizing. Be sure the cleaning procedures you follow are in accordance to any local health codes.