

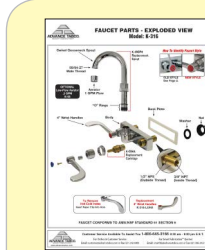

# K-59 3-1/2" GOOSENECK SPLASH MOUNT FAUCET

Conforms To NSF 61/9 Lead Free Requirements



Click This Link To  
View Assembly Sheet

FAUCET AERATOR CONFORM TO  
ASTM.A112.18.1M • 1.0 GPM/3.8 LP  
THREAD: 55/64 - 27 FEMALE

Item #: \_\_\_\_\_ Qty #: \_\_\_\_\_  
Model #: \_\_\_\_\_  
Project #: \_\_\_\_\_

## FEATURES:

3-1/2" swivel gooseneck spout.  
4" O.C. water supply.  
Quarter-turn wedge style handles.  
Colored hot & cold Indexes.  
1.0 GPM/3.8 LPM Aerator. 60 PSI.

## MATERIAL:

Brass chrome plated body & spout.  
Chrome plated handles.

## DIMENSIONS and SPECIFICATIONS

### Options & Accessories

#### Replacement Spout For K-59 Faucet

3-1/2" Gooseneck Spout Only.

K-59SP



#### Low Flow Aerator

.5 GPM

K-08



#### Replacement Cartridges\*

K-00A (Set of 2)



#### Replacement Handles\*

K-00C (Set of 2)



#### Wrist Handles\*

K-316-LU (Set of 2)

For a Complete faucet with Wrist Handles,  
See our K-316 Spec Sheet.



\*Can Only Be Used On Faucets Purchased After January 2016.  
For Older Faucets, Consult Customer Service.

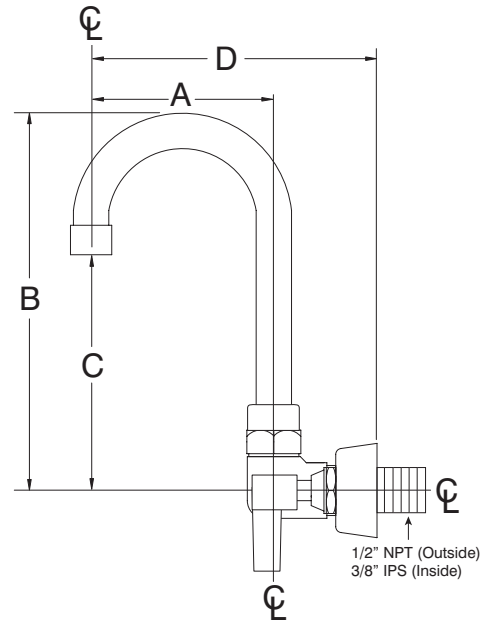

A Length	B Height	C	D	On Center Dimensions
3 1/2"	8 3/8"	5 1/2"	5 3/4"	4" O.C.

## WARNING:

Faucet(s) on this page may expose you to chemicals, including lead, that are known to the State of California to cause cancer or birth defects or other reproductive harm. For more Info., visit [www.p65warnings.ca.gov](http://www.p65warnings.ca.gov).



Customer Service Available To Assist You **1-800-645-3166** 8:30 am - 8:00 pm E.S.T.

For Orders & Customer Service:

Email: [customer@advancetabco.com](mailto:customer@advancetabco.com) or Fax: 631-242-6900

For Smart Fabrication™ Quotes:

Email: [smartfab@advancetabco.com](mailto:smartfab@advancetabco.com) or Fax: 631-586-2933