



# CATALOG OF REPLACEMENT PARTS

## TOASTER

|      |          |
|------|----------|
| ET13 | ML-43312 |
| ET26 | ML-43313 |
| ET27 | ML-43314 |
| ET27 | ML-43311 |

THIS MANUAL REPLACES AND SHOULD BE  
USED INSTEAD OF FORM 15444 (5-84)

### PRIOR ML'S COVERED IN THIS MANUAL

|      |          |
|------|----------|
| ET13 | ML-43106 |
| ET26 | ML-43107 |
| ET27 | ML-43108 |

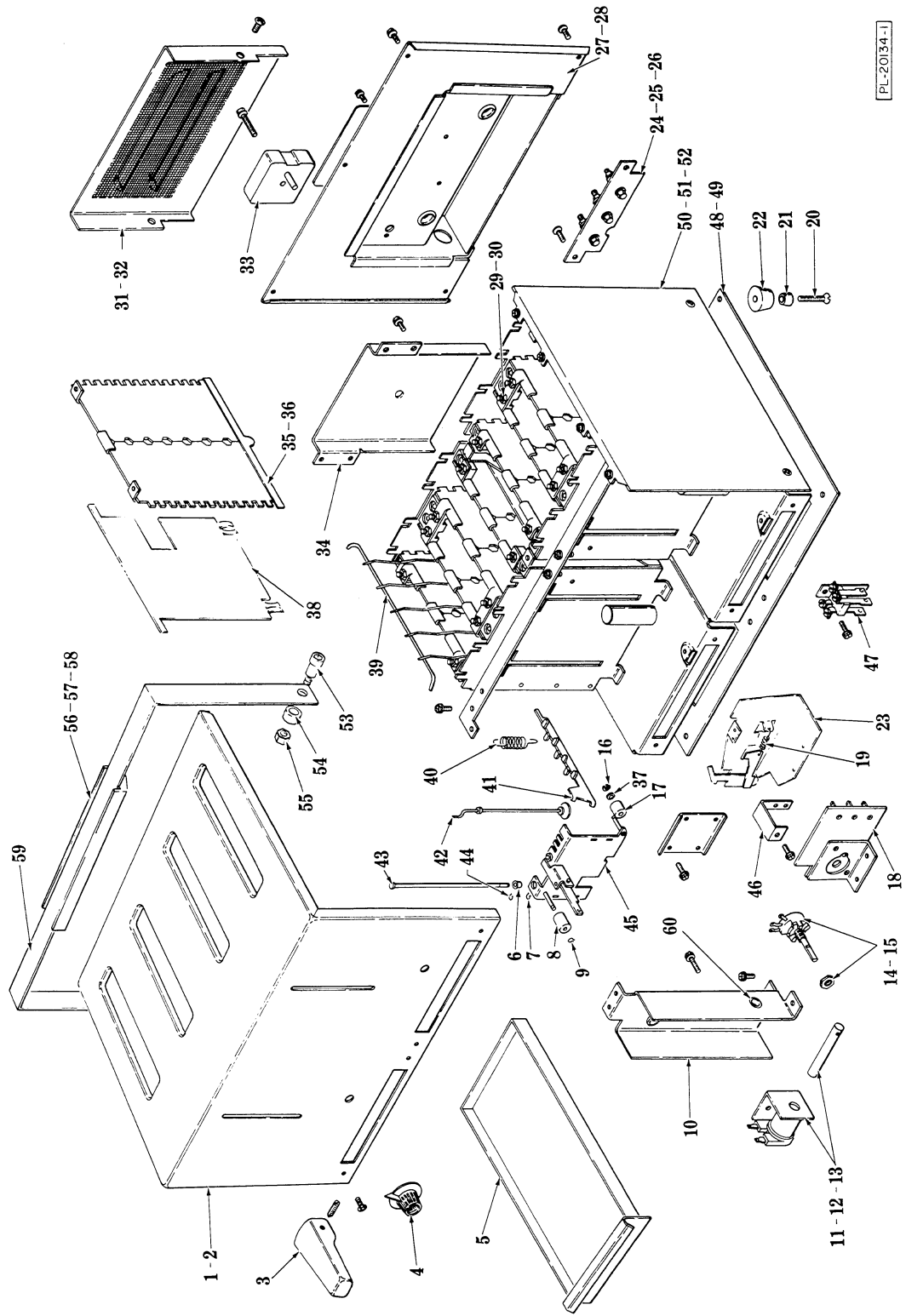

PL-2034-1

SOLID STATE CONTROL TOASTER

## SOLID STATE CONTROL TOASTER

| ILLUS.<br>PL-20134-1 | PART<br>NO. | NAME OF PART  | AMT. |
|----------------------|-------------|---|------|
| 1                    | 353355-3    | Shell (ET13)  | 1    |
| 2                    | 353356-3    | Shell (ET26 & ET27)   | 1    |
| 3                    | 341570-2    | Handle & Set Screw Assy. - Carriage                           | 2    |
| 4                    | 341569-2    | Knob - Color Control  | 2    |
| 5                    | 346910-2    | Crumb Tray  | 2    |
| 6                    | 352853-1    | Bushing   | 8    |
| 7                    | RR-11-51    | Retaining Ring  | 8    |
| 8                    | 352848-1    | Roller  | 2    |
| 9                    | RR-11-48    | Retaining Ring  | 2    |
| 10                   | 346906-1    | Bracket - Solenoid  | 2    |
| 11                   | 346915-1    | Solenoid & Shaft (120 V.)                                     | 2    |
| 12                   | 346915-2    | Solenoid & Shaft (208 V.)                                     | 2    |
| 13                   | 346915-3    | Solenoid & Shaft (240 V.)                                     | 2    |
| 14                   | 346918-2    | Potentiometer (W/3 Leads)                                     | 2    |
| 15                   | 354267-1    | Potentiometer (W/2 Leads)                                     | 2    |
| 16                   | RR-11-48    | Retaining Ring  | 2    |
| 17                   | 352849-1    | Roller  | 2    |
| 18                   | 346965-2    | Bracket - Potentiometer                                       | 2    |
| 19                   | 347397-1    | Spring - Latch  | 2    |
| 20                   | 341576-1    | Foot Screw  | 4    |
| 21                   | 341577-1    | Foot Pad  | 4    |
| 22                   | 341789-2    | Foot  | 4    |
| 23                   | 347725-1    | Frame & Latch Assy. (Incls. item 19)                          | 2    |
| 24                   | 346979-1    | Terminal Board (ET13)   | 1    |
| 25                   | 346980-1    | Terminal Board (ET26 & ET27) (120/208/240 V.)                 | 1    |
| 26                   | 346981-1    | Terminal Board (ET26 & ET27) (208/240 V.)                     | 1    |
| 27                   | 335699-2    | Back Assy. (ET13)   | 1    |
| 28                   | 335700-2    | Back Assy. (ET26 & ET27)                                      | 1    |
| 29                   | 347332-1    | Insulator   | 8    |
| 30                   | 341855-2    | Screw   | 8    |
| 31                   | 346955-2    | Cover - Terminal Box (ET13)                                   | 1    |
| 32                   | 346930-2    | Cover - Terminal Box (ET26 & ET27)                            | 1    |
| 33                   | 352668-1    | Timer   | 2    |
| 34                   | 346908-1    | Shield  | 2    |
| 35                   | 352833-11   | Heating Element (120/240 V.)                                  | 8    |
| 36                   | 352833-12   | Heating Element (208 V.)                                      | 8    |
| 37                   | WS-29-95    | Washer  | 2    |
| 38                   | 352535-1    | Reflector   | 2    |
| 39                   | 341583-1    | Bread Guard   | 8    |
| 40                   | 347398-1    | Spring - Carriage   | 2    |
| 41                   | 354265-1    | Rack - Bread  | 4    |
| 42                   | 352903-1    | Plunger - Dash Pot  | 2    |
| 43                   | 347342-1    | Rod - Carriage  | 2    |
| 44                   | RR-11-50    | Retaining Ring  | 2    |
| 45                   | 352841-3    | Carriage & Lever Assy. (Incls. items 6, 7, 8, 9, 16, 17 & 37) | 2    |
| 46                   | 346912-1    | Lever - Arm   | 2    |
| 47                   | 352904-1    | Switch - Main   | 2    |
| 48                   | 341574-1    | Bottom (ET13)   | 1    |
| 49                   | 341575-1    | Bottom (ET26 & ET27)  | 1    |
| 50                   | 341562-4    | Panel - Side (ET13, ET26 & ET27 W/O Handle)                   | 2    |
| *51                  | 353542-3    | R.H. Side Panel Assy  | 1    |
| *52                  | 353542-4    | L.H. Side Panel Assy  | 1    |
| *53                  | SC-116-19   | Shoulder Screw 1/4-20 Thd. (5/16 x 3/8 Shoulder)              | 2    |
| *54                  | 353540-1    | Space   | 2    |
| *55                  | 341775-1    | Lock Nut 1/4-20 Hex   | 2    |
| *56                  | 347711-1    | Grip  | 1    |
| *57                  | SC-114-10   | Mach. Screw 8-32 x 1/4 Phil. Pan Hd                           | 2    |
| *58                  | WS-29-45    | Washer  | 2    |
| *59                  | 353548-2    | Handle Assy. (Incls. items 56, 57 & 58)                       | 1    |
| 60                   | 347016-1    | Bearing - Solenoid Shaft                                      | 1    |
|                      | 341586-1    | Cord & Plug (115 V., 3 Wire)                                  | 1    |
|                      | 341586-2    | Cord & Plug (208/240 V., 3 Wire)                              | 1    |
|                      | 347775-1    | Cord & Plug (120/208/240 V., 4 Wire)                          | 1    |
|                      | 341571-1    | Strain Relief   | 1    |
|                      | 342325-1    | Adapter - Strain Relief                                       | 1    |
|                      | 342354-1    | Connector - Cable   | 1    |

Quantities are for 4 Slice Toaster; Quantities for other models may vary.

\*ET27 With Handle.

